

## Recreational Trail Program Grant Application – Potential Project Exhibits

### Project 1 – Highway 76 Trailhead and Natural Gardens

Construction of a new trailhead on State Highway 76/112. The site is located on City property in the 400 block of South State Highway 76 and offers a high profile location on the route to Roaring River State Park. The development concept is to quickly transition from the parking area to a naturalized setting that not only provides access to the existing trail but is a picturesque and tranquil attraction in and of itself. The project would include landscaped berms, native trees and landscaping with species selected to attract and support birds and insects. A meandering asphalt walking path and seating area will be nestled within the natural garden.

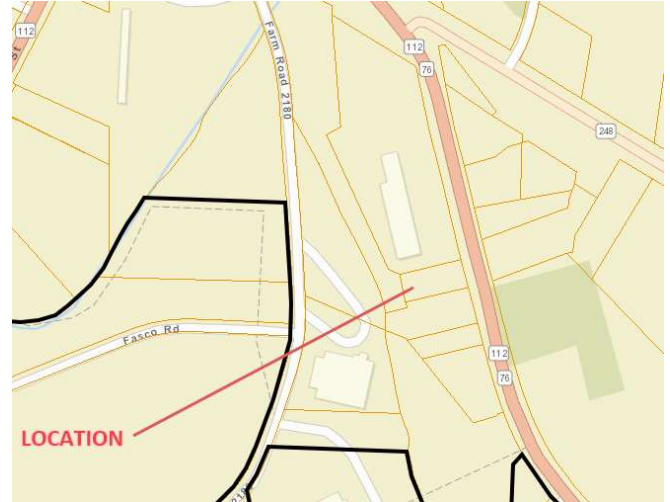

Continued on the following page -

# Recreational Trail Program Grant Application – Potential Project Exhibits

## Project 2 – Greenway Trail Asphalt Paving

Asphalt paving of gravel trails between the Downtown Park Trailhead and 13<sup>th</sup> Street. For flood-damage prevention, trail improvements on facilities lying below the 100-year base flood elevation would include 4" x 12" concrete curb edging. The project would pave just under 3,000 feet of gravel trail and provide flood damage protection for almost 2,700 feet of existing trail.

